

# INSTRUCTION

LINEDO  
951260.833.776.004

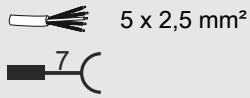

≈ 220 - 240 V 0/50/60 Hz IP 54 IK03



Umgebungstemperatur /  
temperature ambiante  
=> -25 °C ... + 40 °C

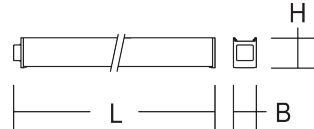
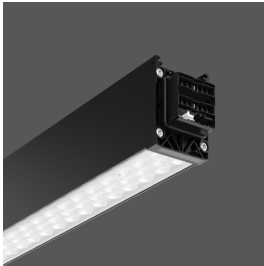

L 1163, B 58, H 76



LED



2,63 kg

$\Phi_{\text{H}}$  [lm]

9750

$P_{\text{H}}$  [W]

71

$P_{\text{L}}$

2 x 19,7 W

CCT [K]

3000

CRI

80

RG  $\text{\textcircled{H}}$

RG 1

EEK  $\text{\textcircled{H}}$

A++

EEK  $\text{\textcircled{H}}$

A++



5 A / 900  $\mu$ s

$B_{10}$  [St.]

18

$B_{16}$  [St.]

32

$C_{10}$  [St.]

34

$C_{16}$  [St.]

54

$P_f$

0,98

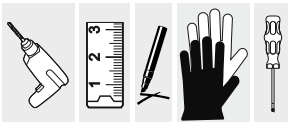

INSTRUCTION  
WARTUNGSPLAN/  
MAINTENANCE  
SCHEDULE



DIN EN 61340-5-1



EN 12464

EN 13201



EN 12464

EN 13201

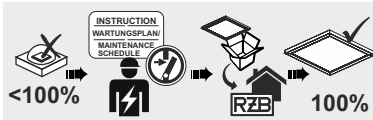

<100%

100%

EN 12464

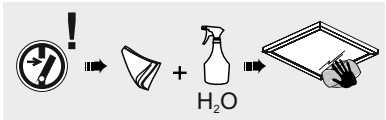

H<sub>2</sub>O



1

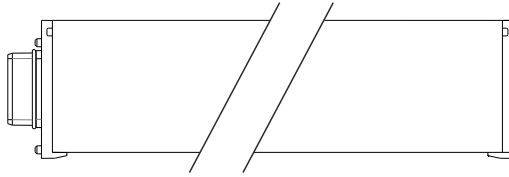

2a

	L	X*
4547 mm	≤ 4500 mm	≤ 60000 mm
2291 mm	≤ 2270 mm	≤ 50000 mm

\* R<sub>PE</sub> < 0,5 Ω  
EN 60598

2b

	L	X*
4547 mm	≤ 4500 mm	≤ 60000 mm
2291 mm	≤ 2270 mm	≤ 50000 mm

\* R<sub>PE</sub> < 0,5 Ω  
EN 60598

2c

	L	X*
4547 mm	≤ 2200 mm	≤ 60000 mm
2291 mm	≤ 1100 mm	≤ 50000 mm

\* R<sub>PE</sub> < 0,5 Ω  
EN 60598

4547 mm  
2291 mm  $\geq 2x$

< 2291 mm  $\geq 1x$



**2d**

$\leq 7 \text{ kg}$

210 mm

500 mm

$A \leq 500 \text{ mm}$

	L	* X
4547 mm	$\leq 2200 \text{ mm}$	$\leq 60000 \text{ mm}$
2291 mm	$\leq 1100 \text{ mm}$	$\leq 50000 \text{ mm}$

\*  $R_{PE} < 0,5 \Omega$   
EN 60598

4547 mm  
2291 mm  $\geq 2x$

$< 2291 \text{ mm} \geq 1x$

**3**

**4**

$\text{Ø}5,2$

SW 14

**5**

24 mm

SW 7

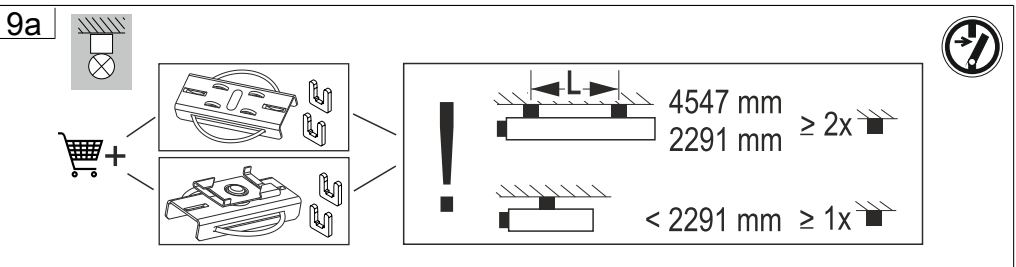
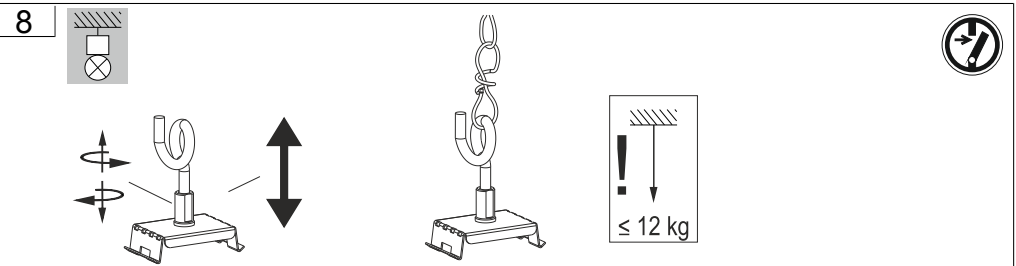
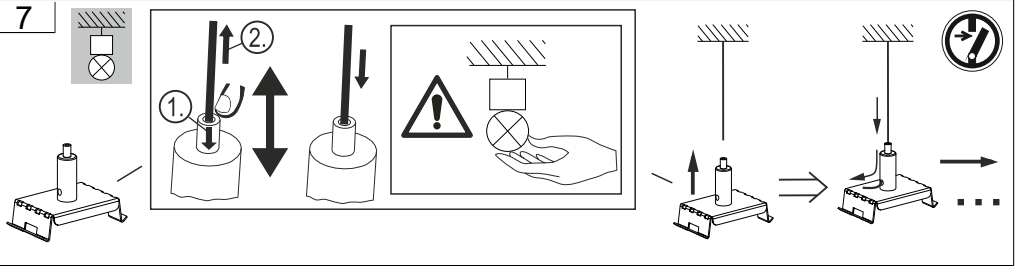
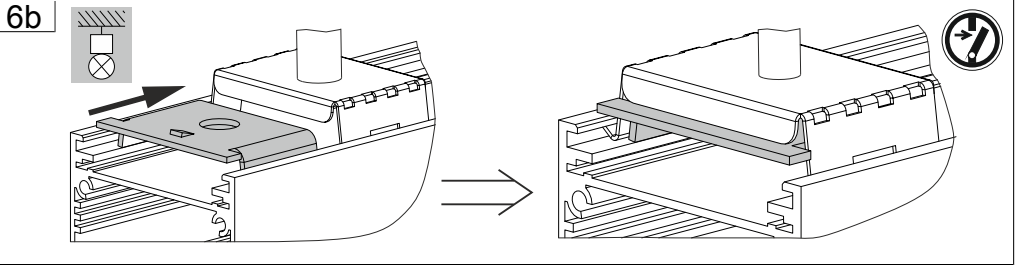
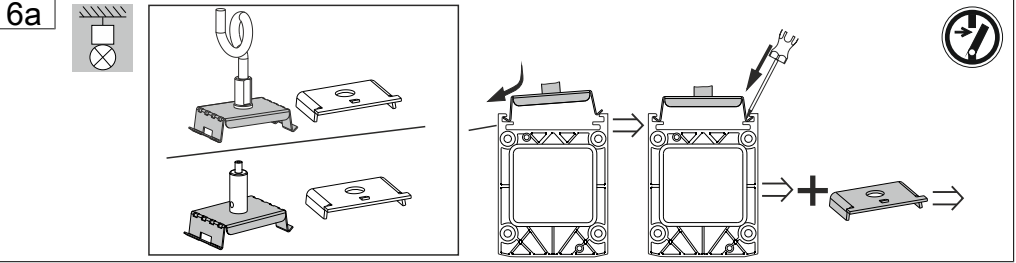

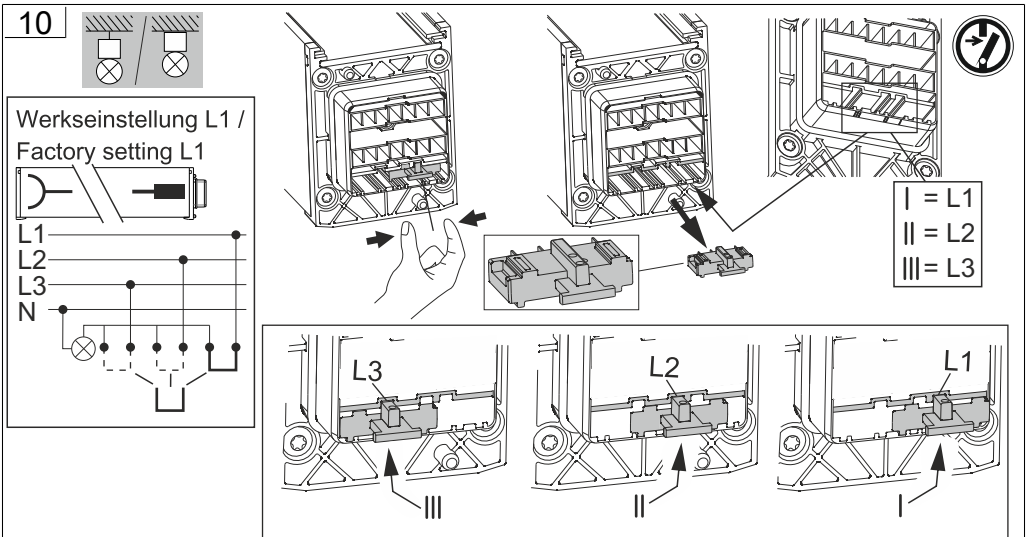
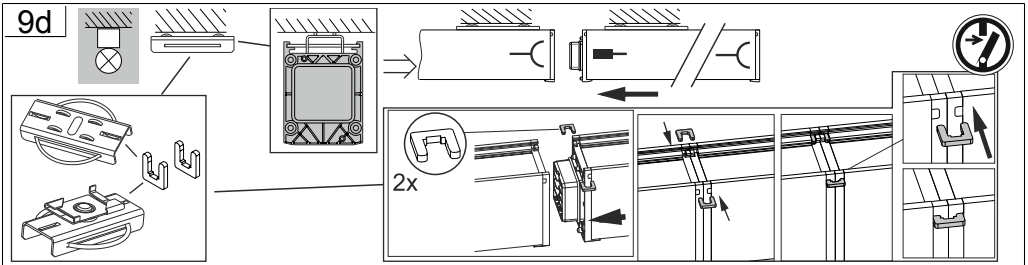
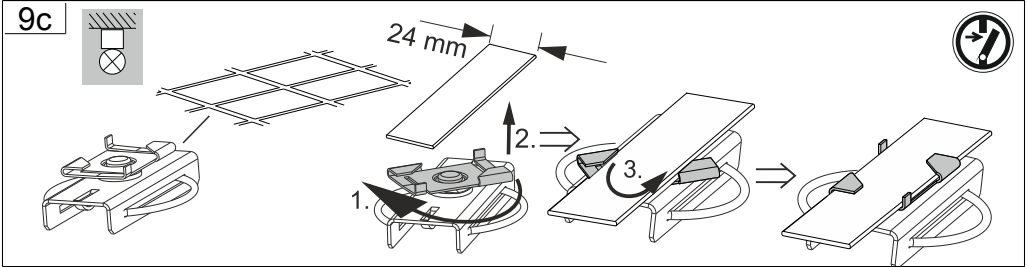
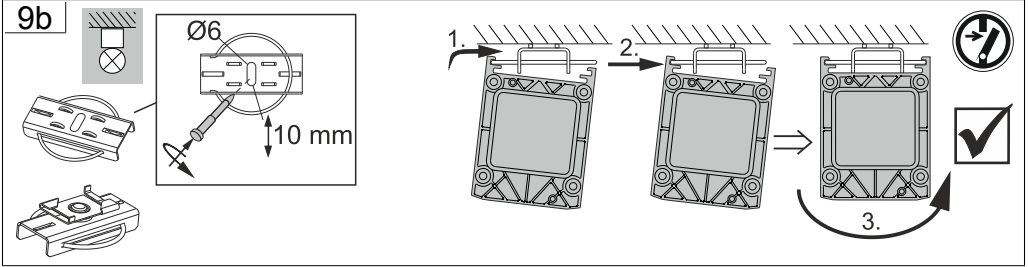

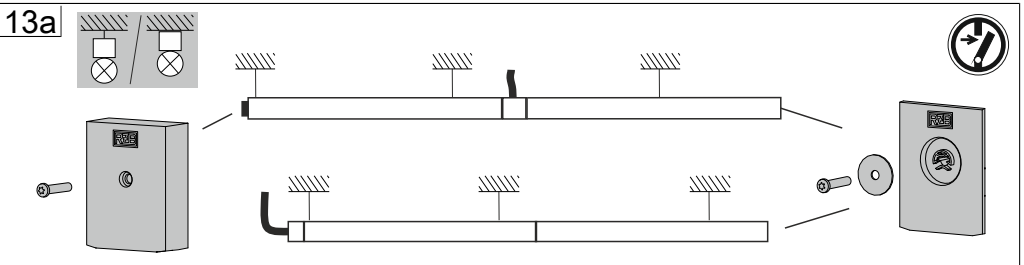
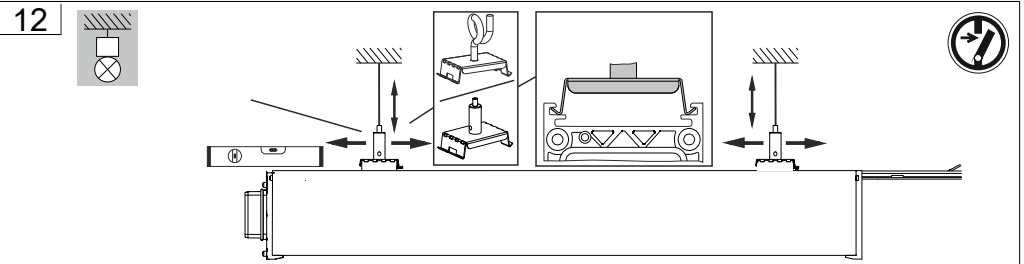
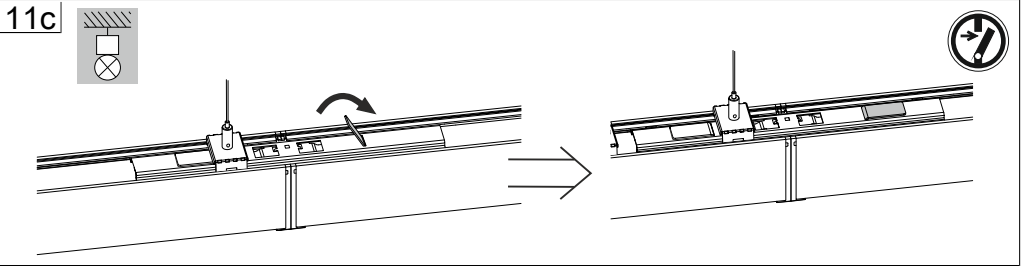
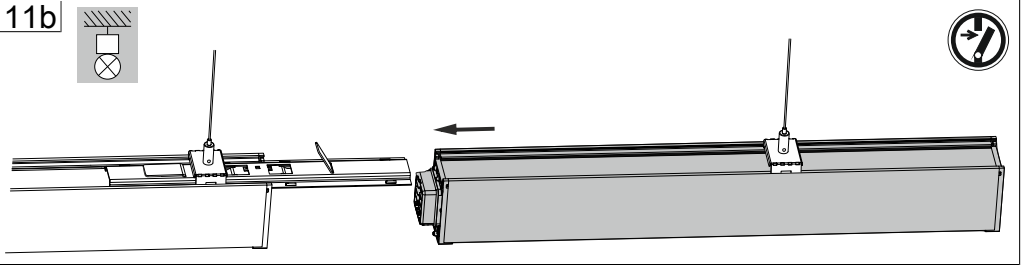
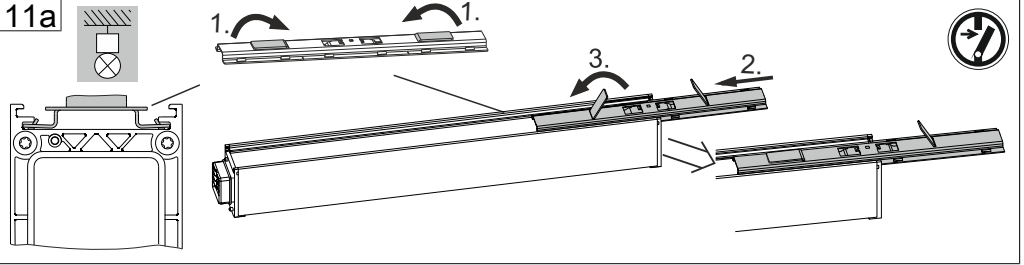



13b

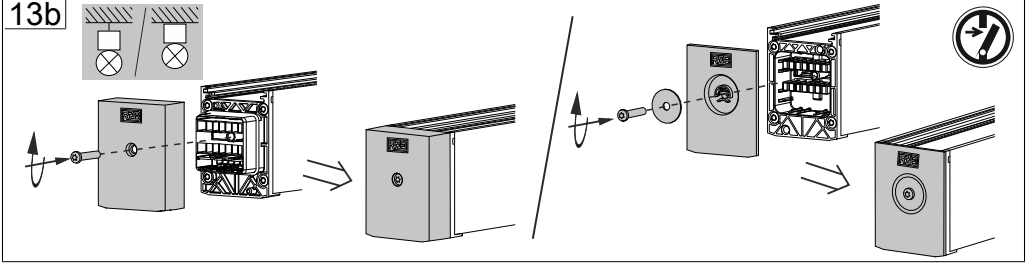

14

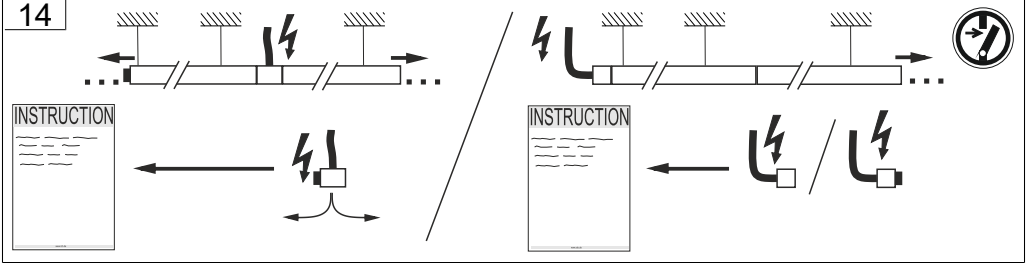



Bei Fragen zu unseren Symbolen,  
besuchen Sie folgende Webseite:

If you have any questions about our  
signs, visit the following website:



[www.rzb.de/fileadmin/assets/downloads/PDF/RZB\\_Symbolklaerung.pdf](http://www.rzb.de/fileadmin/assets/downloads/PDF/RZB_Symbolklaerung.pdf)

	Pendelmontage / Pendant mounting Einspeisung von der Seite / Feed from the side		Stecker / Plug
	Deckenmontage / Ceiling mounting Einspeisung von der Seite / Feed from the side		Buchse / Socket
	Pendelmontage / Pendant mounting Einspeisung von Oben / Feed from above		Pendelmontage / Pendant mounting
	Deckenmontage / Ceiling mounting Einspeisung von Oben / Feed from above		Deckenmontage / Ceiling mounting

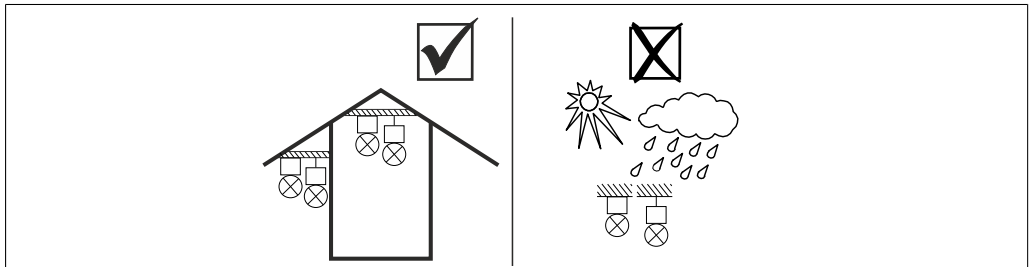
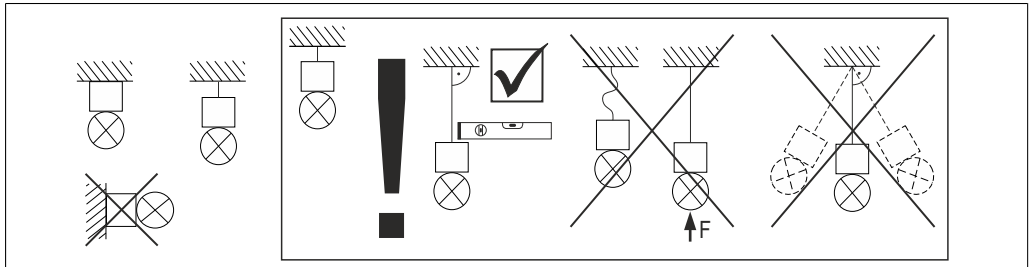

**Hinweis zum Einsatz von Leuchten mit  $\text{D}$ -Kennzeichnung nach EN 60598-2-24**  
**Reference for application of lumiaires with  $\text{D}$ - marking according to EN 60598-2-24**





	Umgebung ohne Staubablagerung Environment without dust deposit
	Umgebung mit nicht elektrisch leitender Staubablagerung Environment with non-electrically conductive dust deposit
	Umgebung mit elektrisch leitender Staubablagerung Environment with electrically conductive dust deposit



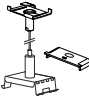

	982678.003.2	Einspeisung Feed	L 312, B 58, H 76	673 g
	982678.003.3	Einspeisung Feed	L 330, B 58, H 76	673 g
	982698.003.3	Einspeisung Feed	L 330, B 58, H 76	751 g
	982698.003.4	Einspeisung Feed	L 312, B 58, H 76	751 g
	982698.003.5	Einspeisung Feed	L 349, B 58, H 76	751 g
	982661.000	Pendelset Pendant kit	, LP 1500	56 g
	982662.000	Pendelset Pendant kit	, LP 1500	240 g
	982663.000	Befestigungsset Fixture	L 33, B 54,	63 g
	982664.000	Befestigungsset Fixture	L 33, B 54,	39,1 g
	982665.000	Pendelset Pendant kit	, LP 1500	80 g
	982717.000	Pendelset Pendant kit	, LP 5000	190 g
	982718.000	Pendelset Pendant kit	L 54, B 30, H 14, LP 5000	240 g

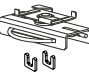
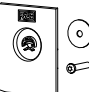
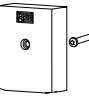

	982719.000	Pendelset Pendant kit	L 54, B 30, H 42, LP 5000	270 g
	982580.010	Deckenmontageset Ceiling surface mounting kit	L 70, B 28, H 16	44 g
	982666.000	Befestigungsset Fixture	L 70, B 54, H 22	25 g
	982699.003	Endkappe End cap	L 16, B 58, H 76	21,5 g
	982700.003	Endkappe End cap	L 23, B 58, H 76	31 g
	982680.000	Verbinder Connector	L 300, B 48, H 9	181 g



RZB - Rudolf Zimmermann, Bamberg GmbH  
Rheinstraße 16  
96052 Bamberg

☎ 0951/7909-0  
Fax: 0951/7909-198

E-mail: [info@rzb-leuchten.de](mailto:info@rzb-leuchten.de)