

INSTRUCTION

LINEDO
952330.830.476.500



RZB
LIGHTING

≈ 220 - 240 V 0/50/60 Hz IP 54 IK03

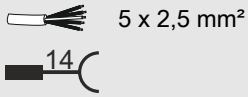

Umgebungstemperatur /
temperature ambiante
=> -25 °C ... + 50 °C

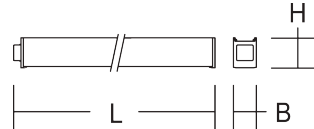
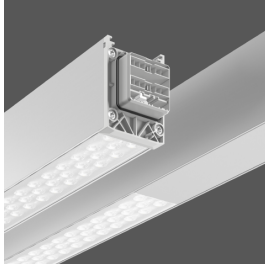

L 2291, B 58, H 76



LED



5,25 kg

Φ_{H} [lm]

3200

P_{H} [W]

21

P_{L}

2 x 19,7 W

CCT [K]

3000

CRI

80

RG $\text{\textcircled{H}}$

RG 1

EEK $\text{\textcircled{H}}$

A++

EEK $\text{\textcircled{H}}$

A++



5 A / 870 μ s

B_{10} [St.]

23

B_{16} [St.]

36

C_{10} [St.]

38

C_{16} [St.]

61

P_f

0,98

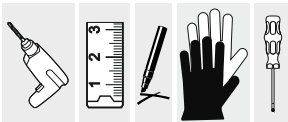

INSTRUCTION
WARTUNGSPLAN/
MAINTENANCE
SCHEDULE



DIN EN 61340-5-1



EN 12464

EN 13201

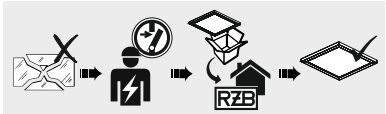

EN 12464

EN 13201

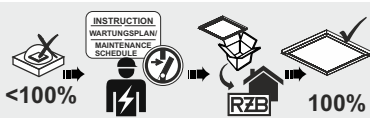

INSTRUCTION
WARTUNGSPLAN/
MAINTENANCE
SCHEDULE

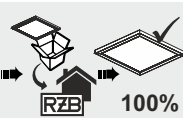

100%

EN 12464

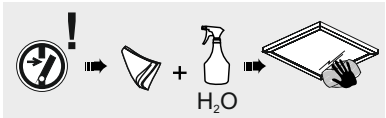

H₂O



1

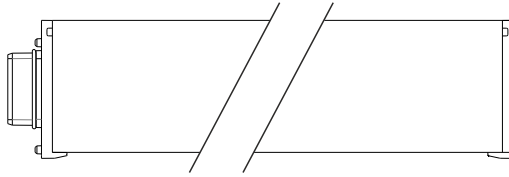

2a

$A \leq 500 \text{ mm}$ X^* $A \leq 500 \text{ mm}$

	L	X*
4547 mm	$\leq 4500 \text{ mm}$	$\leq 60000 \text{ mm}$
2291 mm	$\leq 2270 \text{ mm}$	$\leq 50000 \text{ mm}$

* $R_{PE} < 0,5 \Omega$
EN 60598

! $\downarrow 1x$
 $\leq 12 \text{ kg}$

2b

$A \leq 500 \text{ mm}$ X^* $A \leq 500 \text{ mm}$

	L	X*
4547 mm	$\leq 4500 \text{ mm}$	$\leq 60000 \text{ mm}$
2291 mm	$\leq 2270 \text{ mm}$	$\leq 50000 \text{ mm}$

* $R_{PE} < 0,5 \Omega$
EN 60598

! $\downarrow 1x$
 $\leq 12 \text{ kg}$

2c

500 mm
200 mm X^* $A \leq 500 \text{ mm}$

	L	X*
4547 mm	$\leq 2200 \text{ mm}$	$\leq 60000 \text{ mm}$
2291 mm	$\leq 1100 \text{ mm}$	$\leq 50000 \text{ mm}$

* $R_{PE} < 0,5 \Omega$
EN 60598

! $\downarrow 1x$
 $\leq 7 \text{ kg}$

4547 mm
2291 mm $\geq 2x$

< 2291 mm $\geq 1x$



2d

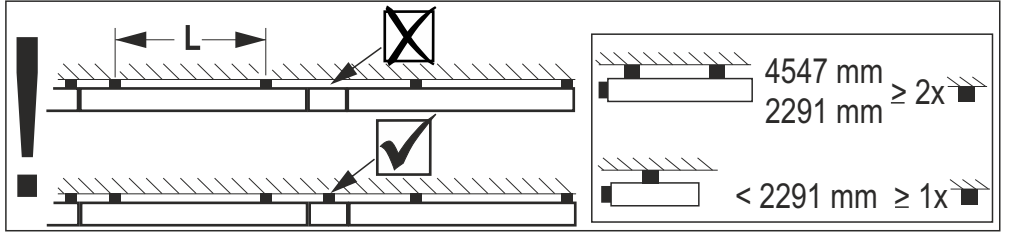
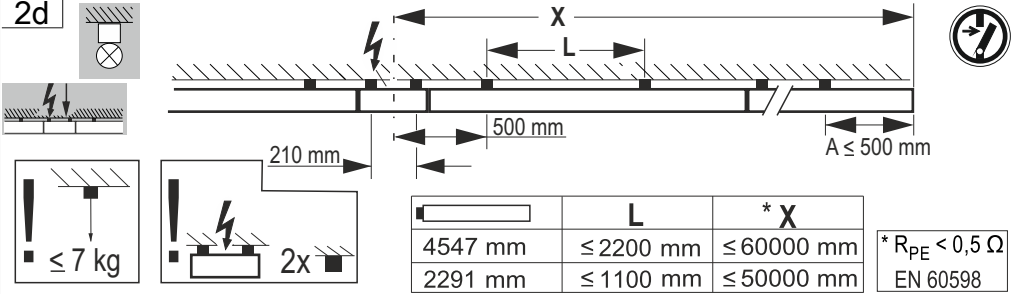

3

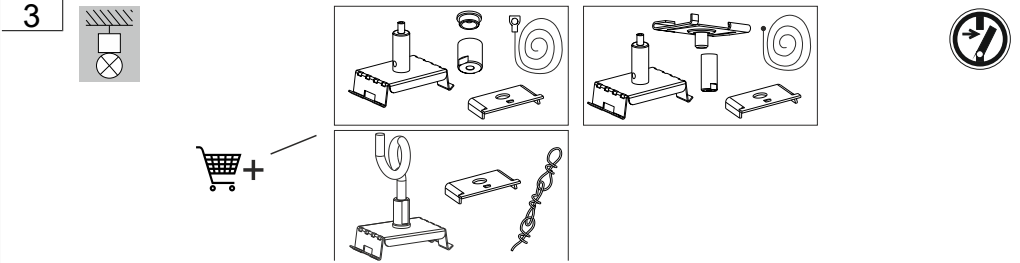

4

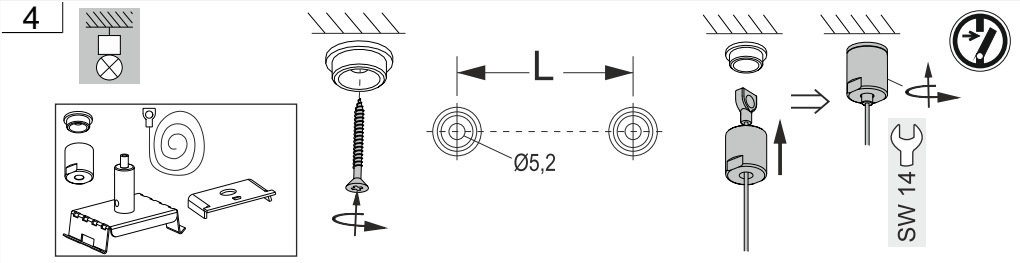

5

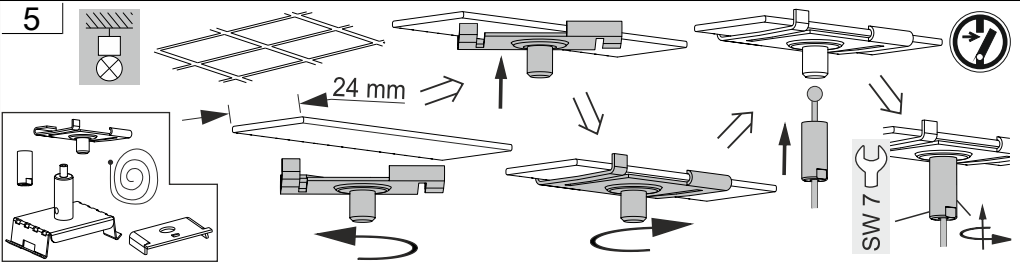



6a

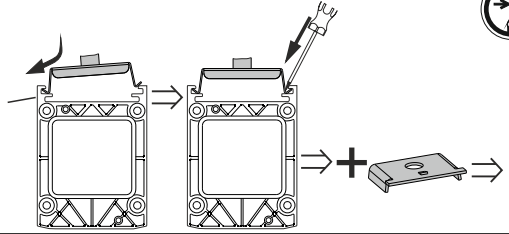
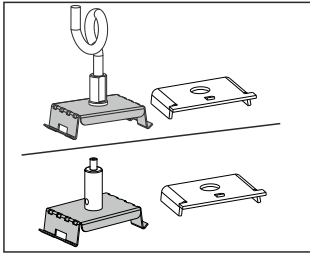

6b

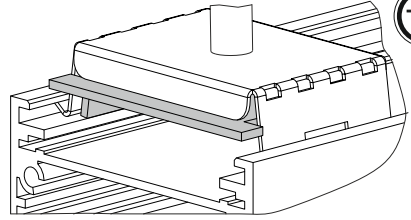
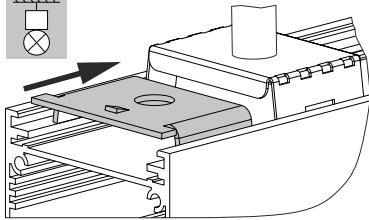

7

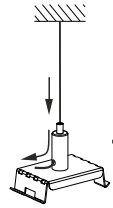
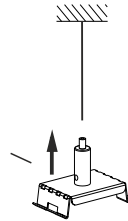
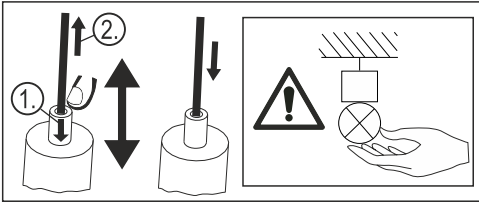
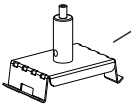

8

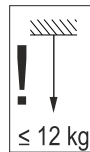
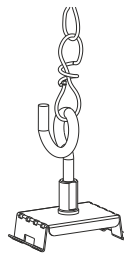
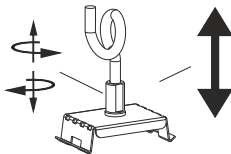

9a

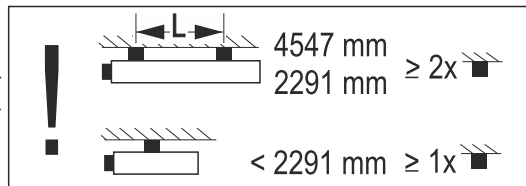
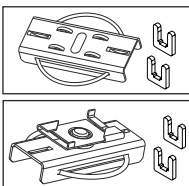

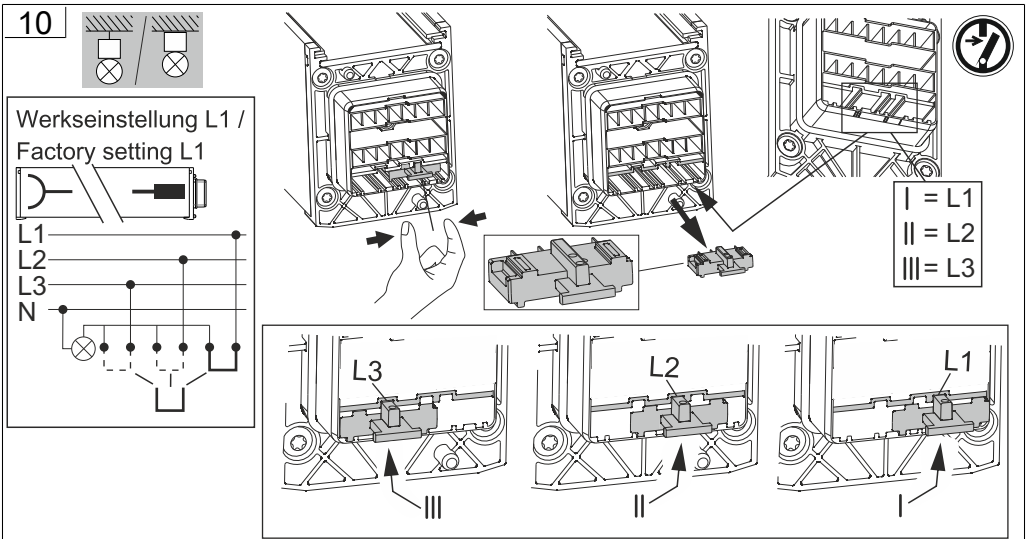
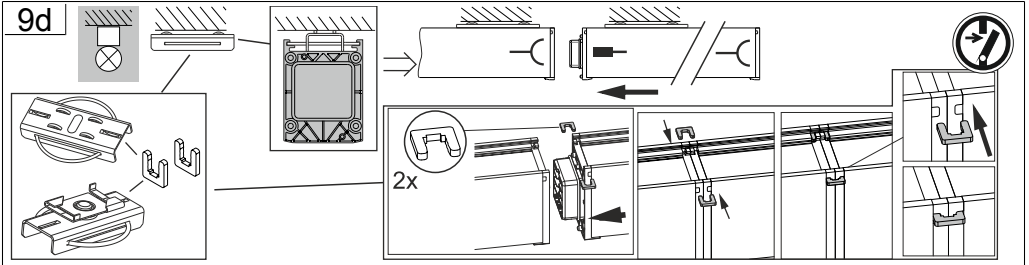
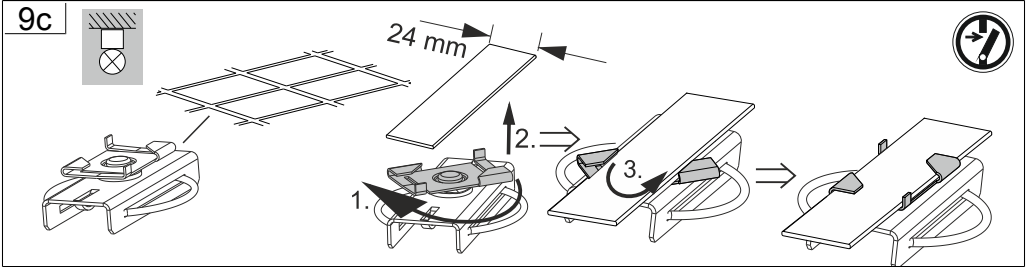
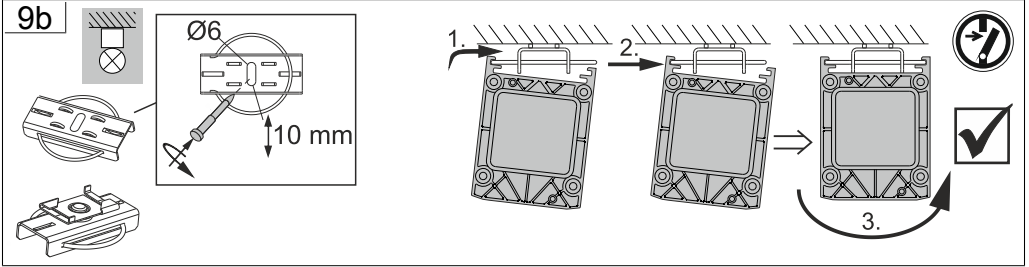

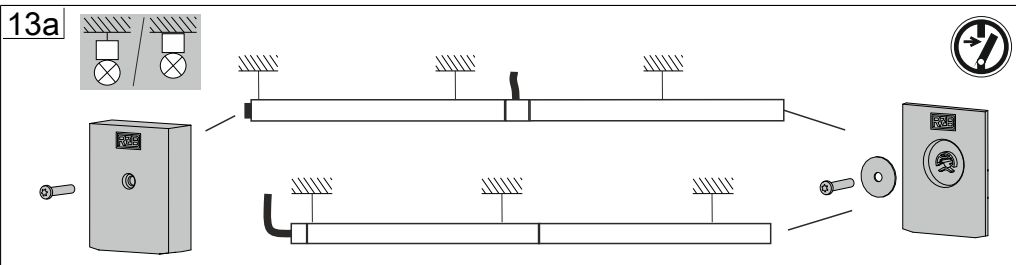
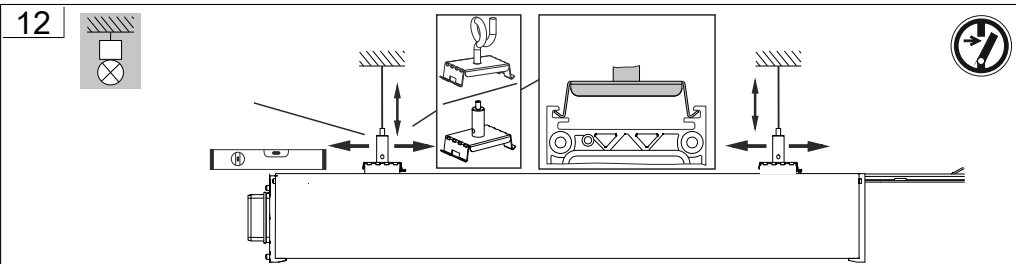
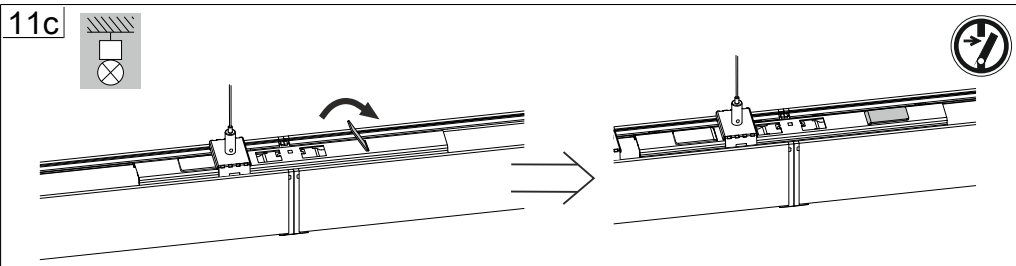
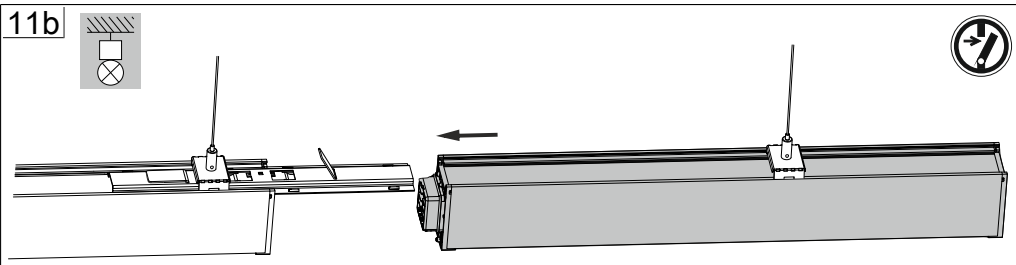
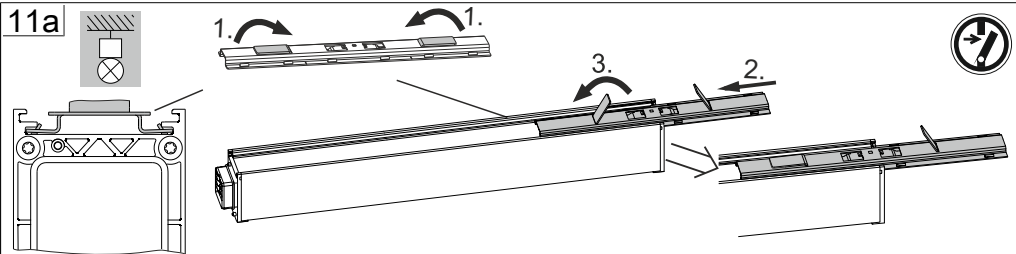



13b

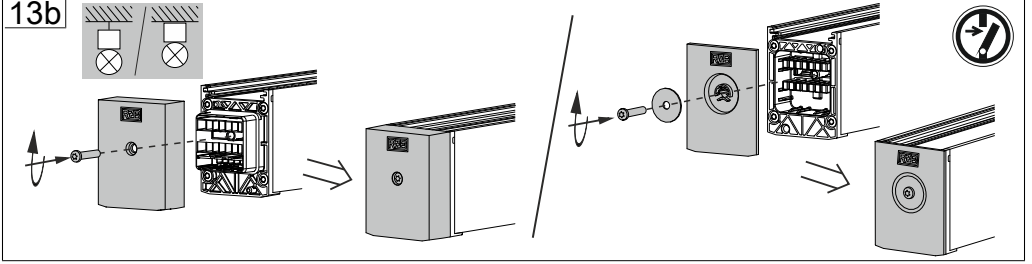

14

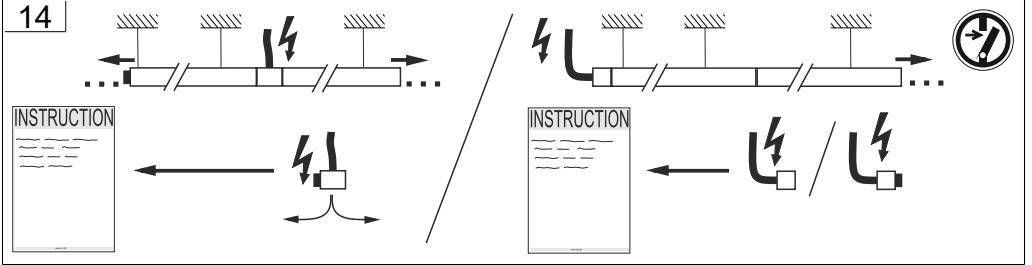



Bei Fragen zu unseren Symbolen,
besuchen Sie folgende Webseite:

If you have any questions about our
signs, visit the following website:



www.rzb.de/fileadmin/assets/downloads/PDF/RZB_Symbolklaerung.pdf

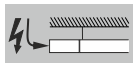

Pendelmontage / Pendant mounting
Einspeisung von der Seite / Feed from the side

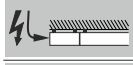

Deckenmontage / Ceiling mounting
Einspeisung von der Seite / Feed from the side

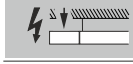

Pendelmontage / Pendant mounting
Einspeisung von Oben / Feed from above



Deckenmontage / Ceiling mounting
Einspeisung von Oben / Feed from above

Stecker / Plug

Buchse / Socket

Pendelmontage /
Pendant mounting

Deckenmontage /
Ceiling mounting

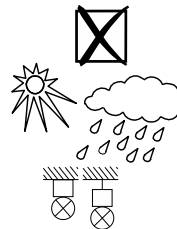
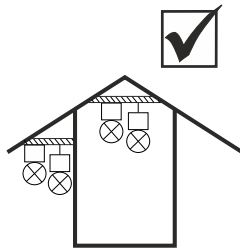
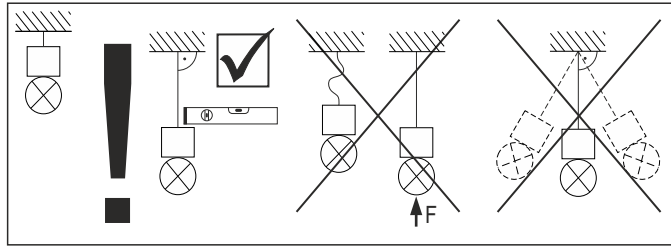
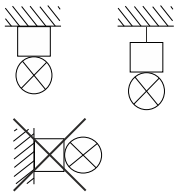

Hinweis zum Einsatz von Leuchten mit ∇ -Kennzeichnung nach EN 60598-2-24
Reference for application of lumiaires with ∇ - marking according to EN 60598-2-24

IP 4x Umgebung ohne Staubablagerung
Environment without dust deposit





IP 5x Umgebung mit nicht elektrisch leitender Staubablagerung
Environment with non-electrically conductive dust deposit

IP 6x Umgebung mit elektrisch leitender Staubablagerung
Environment with electrically conductive dust deposit

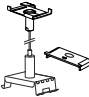

	982678.000	Einspeisung Feed	L 312, B 58, H 76	600 g
	982678.000.1	Einspeisung Feed	L 330, B 58, H 76	728 g
	982698.000	Einspeisung Feed	L 330, B 58, H 76	850 g
	982698.000.1	Einspeisung Feed	L 312, B 58, H 76	850 g
	982698.000.2	Einspeisung Feed	L 349, B 58, H 76	850 g
	982661.000	Pendelset Pendant kit	, LP 1500	56 g
	982662.000	Pendelset Pendant kit	, LP 1500	240 g
	982663.000	Befestigungsset Fixture	L 33, B 54,	63 g
	982664.000	Befestigungsset Fixture	L 33, B 54,	39,1 g
	982665.000	Pendelset Pendant kit	, LP 1500	80 g
	982717.000	Pendelset Pendant kit	, LP 5000	190 g
	982718.000	Pendelset Pendant kit	L 54, B 30, H 14, LP 5000	240 g

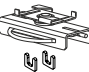
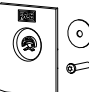
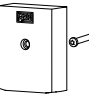

	982719.000	Pendelset Pendant kit	L 54, B 30, H 42, LP 5000	270 g
	982580.010	Deckenmontageset Ceiling surface mounting kit	L 70, B 28, H 16	44 g
	982666.000	Befestigungsset Fixture	L 70, B 54, H 22	25 g
	982699.009	Endkappe End cap	L 16, B 58, H 76	21,5 g
	982700.009	Endkappe End cap	L 23, B 58, H 76	31 g
	982680.000	Verbinder Connector	L 300, B 48, H 9	181 g



RZB - Rudolf Zimmermann, Bamberg GmbH
Rheinstraße 16
96052 Bamberg

☎ 0951/7909-0
Fax: 0951/7909-198

E-mail: info@rzb-leuchten.de